

series	PN	Housing assembly	PIN assembly	Blocked wire	Backup
XXC107-EV-S2TC	A1-XXC107P001	B1-XXC107008	B1-XXC107012	32XXC10703	N Key With interlocking 10mm <sup>2</sup> Unshielded cable
XXC107-EV-S2TC-B	A1-XXC107P002	B1-XXC107009			B Key With interlocking 10mm <sup>2</sup> Unshielded cable
XXC107-EV-S2TC-C	A1-XXC107P003	B1-XXC107010			C Key With interlocking 10mm <sup>2</sup> Unshielded cable
XXC107-EV-S2TC-D	A1-XXC107P004	B1-XXC107011			D Key With interlocking 10mm <sup>2</sup> Unshielded cable
XXC107-EV-S2TB	A1-XXC107P005	B1-XXC107008	B1-XXC107013	32XXC10703	N Key With interlocking 6mm <sup>2</sup> Unshielded cable
XXC107-EV-S2TB-B	A1-XXC107P006	B1-XXC107009			B Key With interlocking 6mm <sup>2</sup> Unshielded cable
XXC107-EV-S2TB-C	A1-XXC107P007	B1-XXC107010			C Key With interlocking 6mm <sup>2</sup> Unshielded cable
XXC107-EV-S2TB-D	A1-XXC107P008	B1-XXC107011			D Key With interlocking 6mm <sup>2</sup> Unshielded cable
XXC107-EV-S2TA	A1-XXC107P009	B1-XXC107008	B1-XXC107014	32XXC10704	N Key With interlocking 2.5-4mm <sup>2</sup> Unshielded cable
XXC107-EV-S2TA-B	A1-XXC107P010	B1-XXC107009			B Key With interlocking 2.5-4mm <sup>2</sup> Unshielded cable
XXC107-EV-S2TA-C	A1-XXC107P011	B1-XXC107010			C Key With interlocking 2.5-4mm <sup>2</sup> Unshielded cable
XXC107-EV-S2TA-D	A1-XXC107P012	B1-XXC107011			D Key With interlocking 2.5-4mm <sup>2</sup> Unshielded cable
XXC107-EV-S2TC-1	A1-XXC107P013	B1-XXC107008	B1-XXC107012	32XXC10703	N Key Without interlocking 10mm <sup>2</sup> Unshielded cable
XXC107-EV-S2TC-B1	A1-XXC107P014	B1-XXC107009			B Key Without interlocking 10mm <sup>2</sup> Unshielded cable
XXC107-EV-S2TC-C1	A1-XXC107P015	B1-XXC107010			C Key Without interlocking 10mm <sup>2</sup> Unshielded cable
XXC107-EV-S2TC-D1	A1-XXC107P016	B1-XXC107011			D Key Without interlocking 10mm <sup>2</sup> Unshielded cable
XXC107-EV-S2TB-1	A1-XXC107P017	B1-XXC107008	B1-XXC107013	32XXC10703	N Key Without interlocking 6mm <sup>2</sup> Unshielded cable
XXC107-EV-S2TB-B1	A1-XXC107P018	B1-XXC107009			B Key Without interlocking 6mm <sup>2</sup> Unshielded cable
XXC107-EV-S2TB-C1	A1-XXC107P019	B1-XXC107010			C Key Without interlocking 6mm <sup>2</sup> Unshielded cable
XXC107-EV-S2TB-D1	A1-XXC107P020	B1-XXC107011			D Key Without interlocking 6mm <sup>2</sup> Unshielded cable
XXC107-EV-S2TA-1	A1-XXC107P021	B1-XXC107008	B1-XXC107014	32XXC10704	N Key Without interlocking 2.5-4mm <sup>2</sup> Unshielded cable
XXC107-EV-S2TA-B1	A1-XXC107P022	B1-XXC107009			B Key Without interlocking 2.5-4mm <sup>2</sup> Unshielded cable
XXC107-EV-S2TA-C1	A1-XXC107P023	B1-XXC107010			C Key Without interlocking 2.5-4mm <sup>2</sup> Unshielded cable
XXC107-EV-S2TA-D1	A1-XXC107P024	B1-XXC107011			D Key Without interlocking 2.5-4mm <sup>2</sup> Unshielded cable

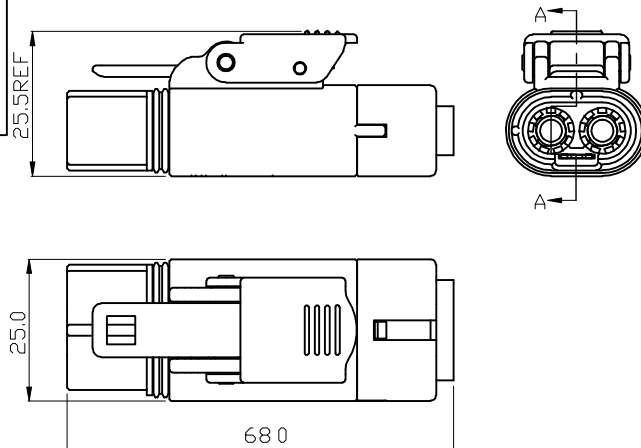
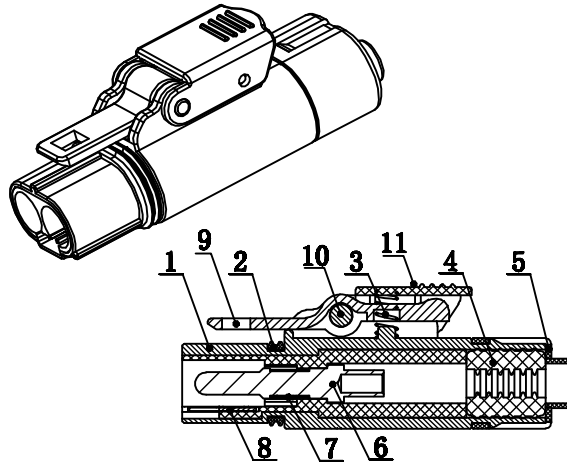
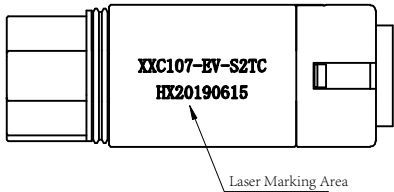
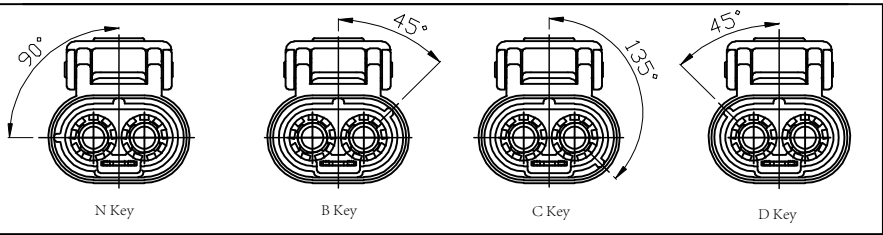

11	13XXC10702	Cover	1 PCS	
10	26XXC10701	Guide Pin	1 PCS	
9	26XXC10702	Pressure plate	1 PCS	
8	23XXC10704	Pin	1 PCS	No interlock without this part
7	24XXC10701	Tooth Bushing	2 PCS	
6	List	φ 4 Pin	2 PCS	
5	13XXC10701	Tailcap	1 PCS	
4	List	Blocked wire	1 PCS	
3	26XXC10703	Spring	1 PCS	
2	32XXC10702	Oring	1 PCS	
1	List	housing assembly	1 PCS	
No	PN	Part Name	NUM	Backup

General Tolerance		Angle Tolerance		POWER DYNAMICS INC. 145 Algonquin Parkway, Whippany, NJ 07981 Phone: 1-973-560-0019 e-mail: sales@powerdynamics.com www.powerdynamics.com			
X ±0.5 .X ±0.2 .XX ±0.1		±1° Unless otherwise specified, dimensions are in metric and tolerances are		DESIGNER	ZsH	TITLE: XX107 High Voltage Metal Connector	
MATL: SEE-NOTES				CHECKED	ZsH	PARTS NO: A1--XXC107P0XX (Plug)	
CUSTOMER-DRAWING				APPROVAL	Qilin		(UNIT): mm (SCALE): 1:1 (SHT): 1/1